



DI GROOVED FITTINGS-GROOVED CONCENTRIC REDUCER

Type: RC

Doc No: DS-400-RC-02-E

1.0 PRODUCT OVERVIEW

Grooved concentric reducer is used for groove pipeline connection. It is mainly applied in the pipeline diameter change. The center of the two ends of the connection is in the same straight line, which can change the flow rate.



Dimensions:

1 1/4"(DN32)– 14"(DN350)

Design Standard:

ISO6182, AWWA C606, GB 5135.11

Connection Standard:

ASME B36.10, ASTM A53-A53M, ISO 4200

Working Pressure:

175PSI-500PSI

Application:

The grooved concentric reducer product is suitable for medium and low pressure pipeline systems with nominal pressure 175-500 PSI, nominal size DN32-DN350, temperature range of - 20 °C -+180 °C , which are widely applied in water supply and drainage, fire-fighting, air conditioning, etc.

Pipe Material:

Welded and seamless rolled steel pipes according to ASME B36.10, ASTM A53-A53M, ISO 4200, GB/T 21835

Surface Treatment:



- Electrophoretic painting
- Epoxy power painting
- Hot-dip galvanizing
- Black
- Others would be available upon clients' detailed request

2.0 APPROVALS

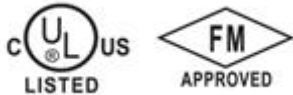

3.0 SPECIFICATIONS-MATERIAL

Ductile iron according to ASTM A536, grade 65-45-12. The nodularity is more than 90%, ensuring excellent physical and mechanical properties.

4.0 DIMENSIONS AND PERFORMANCE

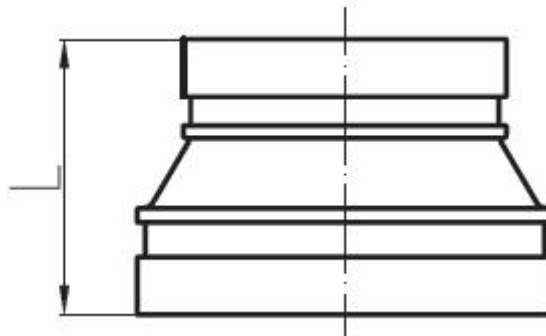

Nominal Size mm/in	Pipe O.D. mm/in	Working Pressure PSI/MPa	Dimensions
			L mm/in
32X25 1 1/4X1	42.4X33.7 1.669X1.327	500 3.45	64 2.50
40X25 1 1/2X1	48.3X33.7 1.900X1.327	500 3.45	64 2.50
40X32 1 1/2X1 1/4	48.3X42.4 1.900X1.669	500 3.45	64 2.50
50X25	60.3X33.7	500	64



2X1	2.375X1.327	3.45	2.50
50X32	60.3X42.4	500	64
2X1¼	2.375X1.669	3.45	2.50
50X40	60.3X48.3	500	64
2X1½	2.375X1.900	3.45	2.50
65X25	73.0X33.7	500	64
2½X1	2.875X1.327	3.45	2.50
65X32	73.0X42.4	500	64
2½X1¼	2.875X1.669	3.45	2.50
65X40	73.0X48.3	500	64
2½X1½	2.875X1.900	3.45	2.50
65X50	73.0X60.3	500	64
2½X2	2.875X2.375	3.45	2.50
65X25	76.1 X33.7	500	64
2½X1	3.000X1.327	3.45	2.50
65X32	76.1X42.4	500	64
2½X1¼	3.000X1.669	3.45	2.50
65X40	76.1X48.3	500	64
2½X1½	3.000X1.900	3.45	2.50
65X50	76.1X60.3	500	64
2½X2	3.000X2.375	3.45	2.50
80X25	88.9X33.7	500	64
3X1	3.500X1.327	3.45	2.50
80X32	88.9X42.4	500	64
3X1¼	3.500X1.669	3.45	2.50
80X40	88.9X48.3	500	64
3X1½	3.500X1.900	3.45	2.50
80X50	88.9X60.3	500	64
3X2	3.500X2.375	3.45	2.50
80X65	88.9X73.0	500	64
3X2½	3.500X2.875	3.45	2.50
80X65	88.9X76.1	500	64
3X2½	3.500X3.000	3.45	2.50
100X50	108.0X60.3	500	76
4X2	4.250X2.375	3.45	3.00
100X65	108.0X73.0	500	76
4X2½	4.250X2.875	3.45	3.00
100X65	108.0X76.1	500	76
4X2½	4.250X3.000	3.45	3.00
100X80	108.0X88.9	500	76
4X3	4.250X3.500	3.45	3.00
100X32	114.3X42.4	500	76



4X1¼	4.500X1.669	3.45	3.00
100X40	114.3X48.3	500	76
4X1½	4.500X1.900	3.45	3.00
100X50	114.3X60.3	500	76
4X2	4.500X2.375	3.45	3.00
100X65	114.3X73.0	500	76
4X2½	4.500X2.875	3.45	3.00
100X65	114.3X76.1	500	76
4X2½	4.500X3.000	3.45	3.00
100X80	114.3X88.9	500	76
4X3	4.500X3.500	3.45	3.00
125X100	133.0X108.0	500	89
5X4	5.236X4.250	3.45	3.50
125X100	133.0X114.3	500	89
5X4	5.236X4.500	3.45	3.50
125X50	139.7X60.3	500	89
5X2	5.500X2.375	3.45	3.50
125X65	139.7X76.1	500	89
5X2½	5.500X3.000	3.45	3.50
125X80	139.7X88.9	500	89
5X3	5.500X3.500	3.45	3.50
125X100	139.7X114.3	500	89
5X4	5.500X4.500	3.45	3.50
125X65	141.3X73.0	500	89
5X2½	5.563X2.875	3.45	3.50
125X65	141.3X76.1	500	89
5X2½	5.563X3.000	3.45	3.50
125X80	141.3X88.9	500	89
5X3	5.563X3.500	3.45	3.50
125X100	141.3X114.3	500	89
5X4	5.563X4.500	3.45	3.50
150X50	159.0X60.3	500	102
6X2	6.260X2.375	3.45	4.00
150X65	159.0X76.1	500	102
6X2½	6.260X3.000	3.45	4.00
150X80	159.0X88.9	500	102
6X3	6.260X3.500	3.45	4.00
150X100	159.0X108.0	500	102
6X4	6.260X4.250	3.45	4.00
150X100	159.0X114.3	500	102
6X4	6.260X4.500	3.45	4.00
150X125	159.0X133.0	500	102



6X5	6.260X5.236	3.45	4.00
150X50	165.1X60.3	500	102
6X2	6.500X2.375	3.45	4.00
150X65	165.1X76.1	500	102
6X2½	6.500X3.000	3.45	4.00
150X80	165.1X88.9	500	102
6X3	6.500X3.500	3.45	4.00
150X100	165.1X108.0	500	102
6X4	6.500X4.250	3.45	4.00
150X100	165.1X114.3	500	102
6X4	6.500X4.500	3.45	4.00
150X125	165.1X139.7	500	102
6X5	6.500X5.500	3.45	4.00
150X125	165.1X141.3	500	102
6X5	6.500X5.563	3.45	4.00
150X50	168.3X60.3	500	102
6X2	6.625X2.375	3.45	4.00
150X65	168.3X73.0	500	102
6X2½	6.625X2.875	3.45	4.00
150X65	168.3X76.1	500	102
6X2½	6.625X3.000	3.45	4.00
150X80	168.3X88.9	500	102
6X3	6.625X3.500	3.45	4.00
150X100	168.3X114.3	500	102
6X4	6.625X4.500	3.45	4.00
150X125	168.3X139.7	500	102
6X5	6.625X5.500	3.45	4.00
150X125	168.3X141.3	500	102
6X5	6.625X5.563	3.45	4.00
200X100	216.3X114.3	300	127
8X4	8.516X4.500	2.07	5.00
200X150	216.3X165.1	300	127
8X6	8.516X6.500	2.07	5.00
200X65	219.1X73.0	500	127
8X2½	8.625X2.875	3.45	5.00
200X80	219.1X88.9	500	127
8X3	8.625X3.500	3.45	5.00
200X100	219.1X108.0	500	127
8X4	8.625X4.250	3.45	5.00
200X100	219.1X114.3	500	127
8X4	8.625X4.500	3.45	5.00
200X125	219.1X139.7	300	127



8X5	8.625X5.500	2.07	5.00
200X125	219.1X141.3	500	127
8X5	8.625X5.563	3.45	5.00
200X150	219.1X159.0	300	127
8X6	8.625X6.260	2.07	5.00
200X150	219.1X165.1	300	127
8X6	8.625X6.500	2.07	5.00
200X150	219.1X168.3	500	127
8X6	8.625X6.625	3.45	5.00
250X150	273.0X159.0	300	152
10X6	10.750X6.260	2.07	6.00
250X150	273.0X165.1	300	152
10X6	10.750X6.500	2.075	6.00
250X150	273.0X168.3	500	152
10X6	10.750X6.625	3.45	6.00
250X200	273.0X219.1	500	152
10X8	10.750X8.625	3.45	6.00
300X150	323.9X168.3	500	178
12X6	12.750X6.625	3.05	7.00
300X200	323.9X219.1	500	178
12X8	12.750X8.625	3.45	7.00
300X250	323.9X273.0	500	178
12X10	12.750X10.750	3.45	7.00
350X200	355.6X219.1	300	203
14X8	14X8.625	2.07	7.99
350X250	355.6X273.0	300	203
14X10	14X10.750	2.07	7.99
350X300	355.6X323.9	300	203
14X12	14X12.75	2.07	7.99

5.0 REFERENCE MATERIALS

Approved certification for Grooved Fittings and Couplings

I-JM-Grooved fitting: Installation Instructions for grooved fittings and couplings