

AWWA MECHANICAL RESILIENT NRS GATE VALVE

Type: Z35XC-2

Doc No: DS-901-Z35XC-2-01-E-X

1.0 PRODUCT OVERVIEW

The valve is mainly used to connect and cut off the medium in the pipeline by rotating the stem. Its transmission thread is inside the body cavity, which can save installation space.



Dimensions:

4" (DN100)-12" (DN300)

Design Standard:

AWWA C515;

Connection Standard:

ANSI/AWWA C111/A21.11-17

Working Pressure:

300PSI; 200PSI;

Application:

This AWWA standard mechanical resilient NRS gate valve is applied at the fire-protection system, the working temperature is 0°C-80°C.

Material of Matching Products:

Grooved valves or fittings of ductile iron, gray iron, cast steel, etc.

Surface Treatment:

- Epoxy power painting (color numbers as RAL3000,RAL3001,etc)
- Painting (color numbers as RAL3000,etc)
- Others would be available upon clients' detailed request

2.0 APPROVALS

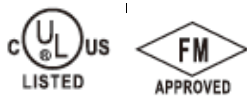

3.0 SPECIFICATIONS

Product Sketch:

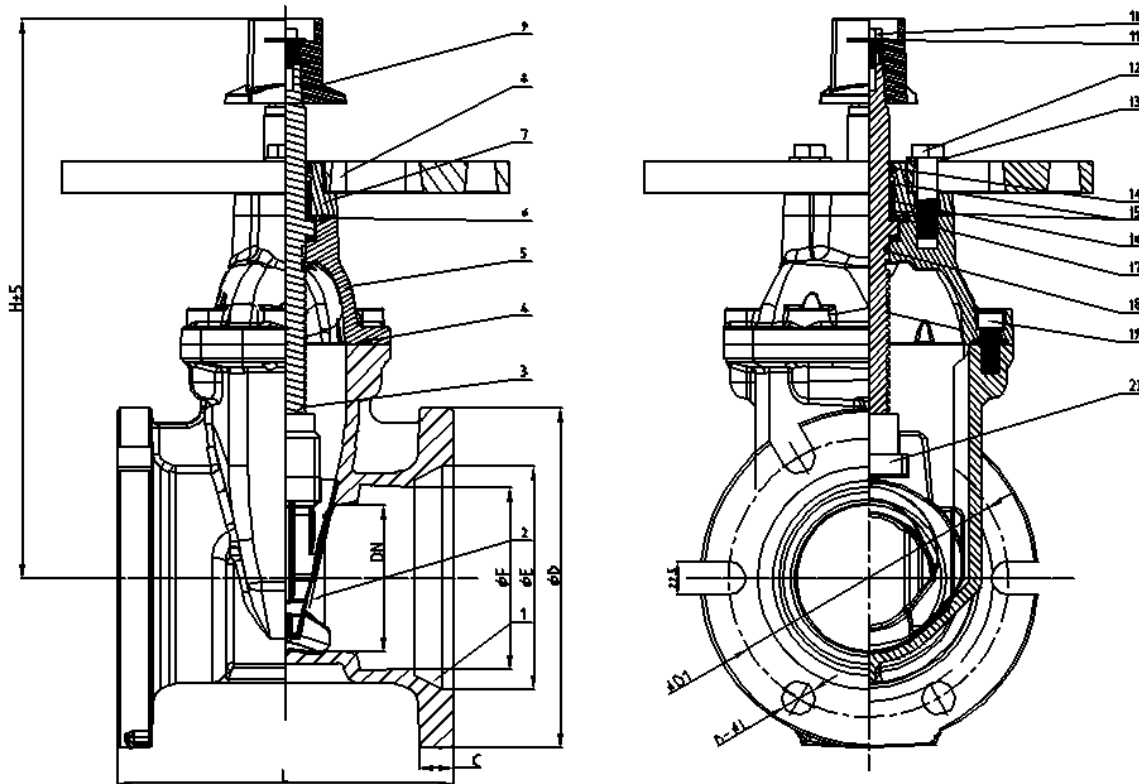

Part No.	Part	Standard Specification	Options
1	Valve Body	Ductile iron 65-45-12	
2	Resilient Wedge disc	Ductile iron 65-45-12+EPDM	
3	Stem	Stainless Steel 1Cr17Ni2	AISI 304、AISI 316、AISI 431
4	Bonnet Gasket	EPDM	
5	Bonnet	Ductile iron 65-45-12	
6	O-Ring	NBR	EPDM
7	Gland	Ductile iron 65-45-12	
8	Indicator Post Flange	Ductile iron 65-45-12	
9	Square Operating Nut	Ductile iron 65-45-12	
10	Bolt	Carbon Steel Zinc Plated	AISI 304、AISI 316、
11	Flat Washer	Carbon Steel Zinc Plated	AISI 304、AISI 316、
12	Nut	Carbon Steel Zinc Plated	
13	Flat Washer	Carbon Steel Zinc Plated	AISI 304、AISI 316、
14	Ring Wiper	EPDM	NBR
15	O-Ring	NBR	EPDM
16	Axis guide	Brass HPb59-1	
17	Washer	Brass HPb59-1	
17	O-Ring	NBR	EPDM
18	Bolt	Carbon Steel Zinc Plated	AISI 304、AISI 316、
19	Nut	Carbon Steel Zinc Plated	
20	Wedge nut	Brass HPb59-1	

4.0 DIMENSIONS AND PERFORMANCE

4.1 Dimensions

DN	Dimensions(mm)
----	----------------

inc h	m m	L	H± 5	∅D	∅D1	∅E	∅F	C	n-∅L
4"	100	22 9	355	23 2	190. 5	152.9+0.6/- 0.4	124.5+0.7/- 0.3	19.1+3/ 0	4- ∅22.2+1.5/0
6"	150	29 2	448	28 2	241. 3	206.2+0.6/- 0.4	177.8+0.7/- 0.3	19.1+3/ 0	6- ∅22.2+1.5/0
8"	200	31 8	548	34 0	298. 5	260.9+0.6/- 0.4	232.4+0.7/- 0.3	22.2+3/ 0	6- ∅22.2+1.5/0
10"	250	37 5	626	39 7	355. 6	313.4+0.6/- 0.4	284.4+0.7/- 0.3	23.8+3/ 0	8- ∅22.2+1.5/0
12"	300	37 8	722	45 4	412. 7	366.7+0.6/- 0.4	337.8+0.7/- 0.3	25.4+3/ 0	8- ∅22.2+1.5/0

4.2 Flow rates

DN	DN100	DN150	DN200	DN250	DN300
Kv	162.8	366.3	651.1	1017.4	1456

5.0 REFERENCE MATERIALS

Approved certification for Gate Valve